

LINGUAL ORDER PROCESS

25 years - around the globe

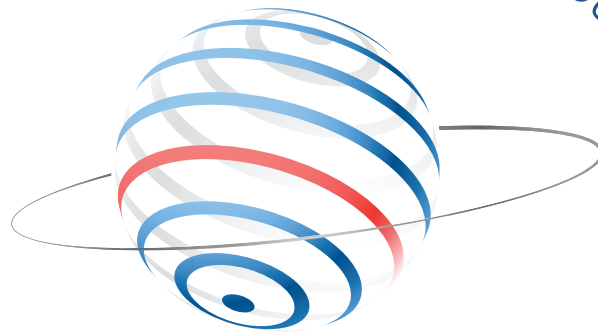

research - design - manufacturing - distribution

# HOW TO SUBMIT YOUR LINGUAL CASE

WE WILL GUIDE YOU STEP BY STEP

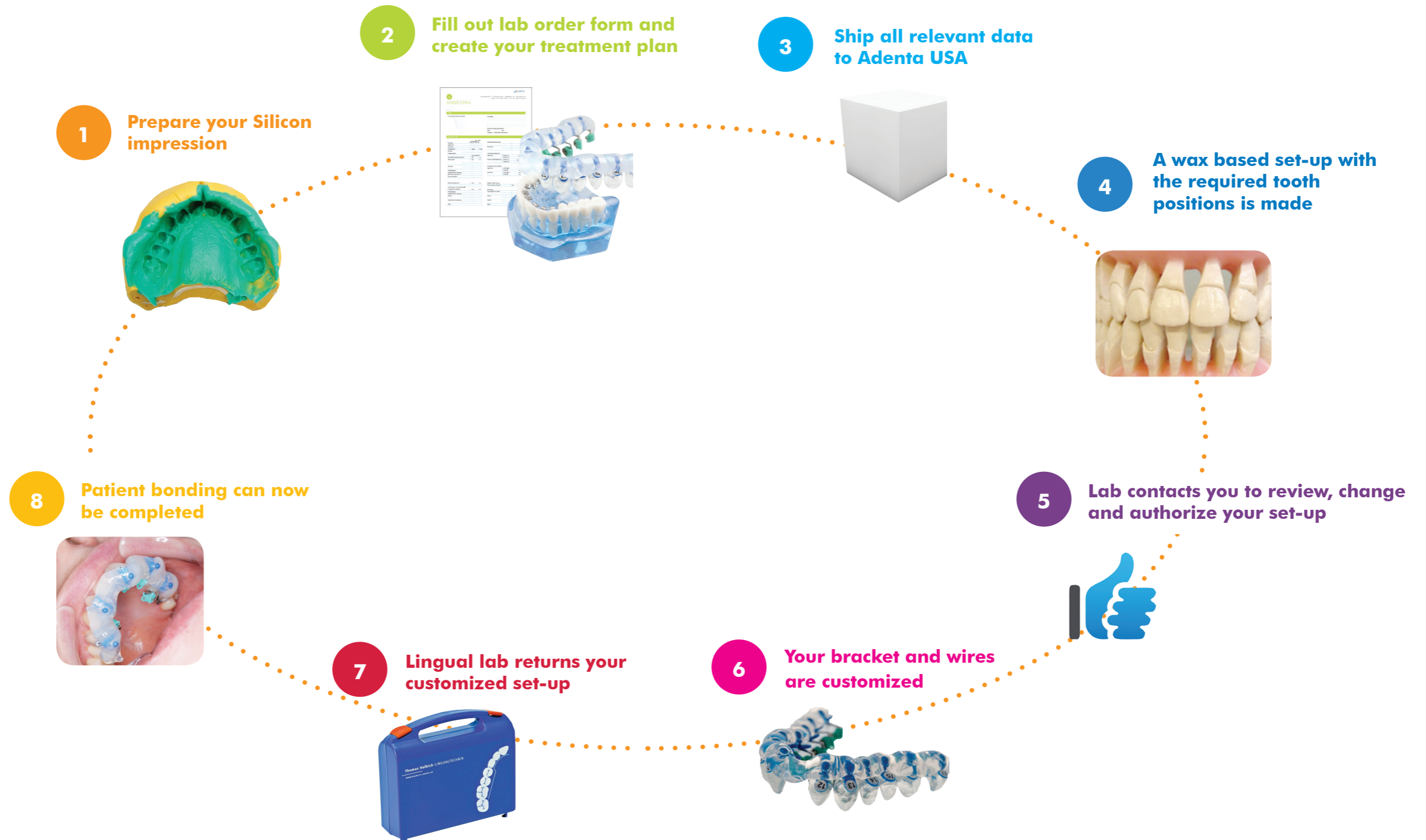

1

# IMPRESSIONS

## A-Silicone-based impression tools and tips

The aim is to provide an accurate representation of the malocclusion using an A-silicone-based impression and a corrective impression.

**Product recommendation:**  
 Panasil Putty Soft  
 Panasil Contact Two in One  
 Plicafol Separating Foil

## Preparation for the impression

### Dental cleaning:

The teeth should have no deposits such as plaque or tartar. Use prophylactic measures where necessary.

### Undercuts:

Crowns with border seals and provisional crowns are especially at risk of coming loose as a result of the dental impression.

Strong undercuts should therefore be blocked out with wax in advance. Interlinks must also be blocked for bridges. All dental caries should be completed by this date. Any new restorative work should, if possible, be postponed until the orthodontic treatment is complete.

## Taking the perfect impression



**A.** Knead the individual components of the putty material together in equal parts (note the handling instructions provided by the manufacturer). Do not use latex gloves during this process, as this material affects the setting properties of the silicone compound. Place slightly more putty in the distal area to create an edge like boundary. Rarely does the tray have to be customized with boxing wax.



**B.** Now place Plicafol separating foil on top of the putty and apply gentle pressure. Fold back or cut off the overlapping parts of the separating foil.



**C.** The initial impression can now be taken from the patient. Forcefully press the tray filled with putty and covered by the foil onto the teeth of the patient. Keep the tray in place by equally and centrally applied constant pressure, so the foil and the putty will surround the teeth – use two fingers in the maxilla on each side and one thumb in the mandible on each side. Push back any putty that spread past the tray with the dental mirror towards the last teeth to be molded.

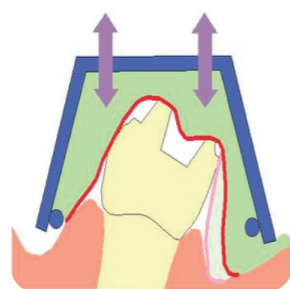

**D.** Move the tray up and down and slightly back and forth immediately after positioning. Doing so ensures that no overlapping areas/undercuts remain and that a large enough space layer is created. Moving the tray allows for the assessment of the repositioning capability of the tray for the later, second impression phase. The up and down movement is especially important in the mandible, where the teeth lean towards the tongue.



**E.** Take out the tray and remove the foil after the putty is set.

Due to the pronounced elasticity of Plicafol, there will be no perforations or folds. The result is a custom made tray without undercuts, showing rough tooth indentations and a defined space layer. The surface is uncontaminated by saliva or blood.

## Second Impression - apply free-flowing silicone

To make the second impression-taking is easier and more comfortable for the patient, any excess putty compound

on the edge of the tray should be cut off. However, anything up to 5 mm from the sulcus should be left in place.

The silicone impression compounds are hydrophilic, however an additional step to dry the teeth with air helps to safeguard the quality of the impression.

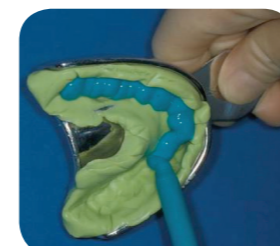

**A.** The following steps represent the actual impression taking. Foil impression is much more comparable with the one-step impression technique than with the two-step dental impression technique.

Fill free-flowing silicone of medium consistency into the pre-impression in a thickness of 3 mm. Put the filled tray aside briefly.



**B.** Coat the teeth, starting at the gingiva in the occlusal direction, coat the air-dried teeth with free-flowing silicone of medium or low consistency by use of the proper syringe until they are covered completely.



**C.** Bring the filled tray evenly and with moderate pressure into position. Hold it in place until the silicone is completely set.

Now the impression is finished and can be removed.

## Impressions Using Bands:

If the impression is taken using bands, please ensure a sufficiently large impression tray is used given the usual buccal attachments. The attachments must also be adequately covered with dental wax for the putty impression in order to create the space required for the corrective compound. The impression can now be taken using the putty compound and Plicafol. However, if the impression is taken without using bands, please enclose the appropriate bands for the impression. The bands will be transferred to the model teeth as part of the work undertaken in the laboratory.

2

# ORDER FORM

## Order

From [Stamp of dental practice]

For patient \_\_\_\_\_  
 \_\_\_\_\_  
 \_\_\_\_\_

Planned bonding appointment\*:  
 Date \_\_\_\_\_ Time \_\_\_\_\_  
 [\*approx. 3 weeks after impressions]

## Treatment plan

Treatment	lingual	vestibular	only set-up	no
Upper jaw	<input type="checkbox"/>	<input type="checkbox"/>	<input type="checkbox"/>	<input type="checkbox"/>
Lower jaw	<input type="checkbox"/>	<input type="checkbox"/>	<input type="checkbox"/>	<input type="checkbox"/>
Pretreatment?	<input type="checkbox"/> upper	<input type="checkbox"/> lower		
Brackets	_____			
Treatment plan:	<input type="checkbox"/> copy attached			
New dental implant planned?	<input type="checkbox"/> yes	<input type="checkbox"/> no		
Ideal set-up?	<input type="checkbox"/> yes	<input type="checkbox"/> no		
Extraction	_____			
ATR (stripping) (Achilles Tendon Rupture)	_____			
Teeth which will retain in the same position	_____			
Bolton-discrepancy?	<input type="checkbox"/> yes	<input type="checkbox"/> no		
Leave a gap in case tooth width in upper jaw increases	<input type="checkbox"/> yes	<input type="checkbox"/> no		
ATR (stripping) (Achilles Tendon Rupture)	_____			
Artistry	_____			
Gap/Dental broadening	_____			
Other	_____			

Gap/Dental broadening \_\_\_\_\_

Protruding \_\_\_\_\_

Transversal Expansion

Upper jaw  Anterior to \_\_\_\_\_ mm  
 Posterior to \_\_\_\_\_ mm

Lower jaw (Straightening)  Anterior to \_\_\_\_\_ mm  
 Posterior to \_\_\_\_\_ mm

Correction of the midline

Upper jaw  to the right \_\_\_\_\_ mm  
 to the left \_\_\_\_\_ mm

Lower jaw  to the right \_\_\_\_\_ mm  
 to the left \_\_\_\_\_ mm

Anterior Teeth Torque

Overcorrection desired?  yes  no

Anchoring

TransPalatal Arch (TPA) \_\_\_\_\_

Nance \_\_\_\_\_

Implant \_\_\_\_\_

Other \_\_\_\_\_

**ATTENTION!**  
 Please select your tray option

## Dental Service and Contact Details

Please send me dental set-up for review  yes  no

Please call me  yes  no

Send me digital photos of dental set-up via email  yes  no E-Mail: \_\_\_\_\_

## Dental Bracket Selection

Adenta	Evolution SLT	Incisals		Premolars		Molars	
		upper	lower	upper	lower	upper	lower
	Joy	<input type="checkbox"/>	<input type="checkbox"/>	<input type="checkbox"/>	<input type="checkbox"/>	<input type="checkbox"/>	<input type="checkbox"/>

## Bracket Transfer Cap Options

Please select:

Pure-caps  Wing-caps with red extension

Pure-caps in a single-tray  Wing-caps with red extension in a double-tray

Pure-caps in a double-tray

## Archwires

		Upper jaw	Lower jaw		Upper jaw	Lower jaw
Heat activated	.012	<input type="checkbox"/>	<input type="checkbox"/>	β-Titan (CNA)	16 x 16	<input type="checkbox"/>
Nickel	.014	<input type="checkbox"/>	<input type="checkbox"/>	Trident	16 x 22	<input type="checkbox"/>
Titanium	.016	<input type="checkbox"/>	<input type="checkbox"/>		17 x 25	<input type="checkbox"/>
(Ultherm)	16 x 16	<input type="checkbox"/>	<input type="checkbox"/>	Stainless	.016	<input type="checkbox"/>
	16 x 22	<input type="checkbox"/>	<input type="checkbox"/>	Steel	16 x 16	<input type="checkbox"/>
	17 x 25	<input type="checkbox"/>	<input type="checkbox"/>	Duradent	16 x 22	<input type="checkbox"/>
Niti	.014	<input type="checkbox"/>	<input type="checkbox"/>		18 x 18	<input type="checkbox"/>

- Additional order options:**
- customized wires
  - individual caps
  - re-positioning of set-up
  - Distalizers

2

## INDIRECT BONDING TRAY OPTIONS



The SMART Lingual indirect bonding system provides a secure, repeatable, fast and precise method customized to the patients' case and habits of the practitioner.

Straight wire appliances make it imperative that the brackets be positioned with accuracy in order to fully exploit the interaction of their written prescription. The SMART Lingual indirect bonding system offers the orthodontist the precision of the Hiro technique with the speed and efficiency of a full bonding tray, or individual tooth cap. You choose which option works best for you - or combine the advantages of both options for ultimate customizing to best suit your needs. This system has complete flexibility, even teeth that are difficult to isolate or re-bonds are simple and easy to handle.

## BONDING OPTIONS

### EVOLUTION SLT™ SMART CAP™ LINGUAL BONDING SYSTEM

Individual SMART CAP™ indirect bonding cap

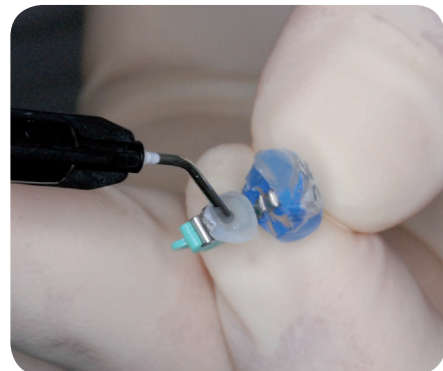

Full tray SMART CAP™ indirect lingual bonding



3

## SHIP TO YOUR LINGUAL LAB

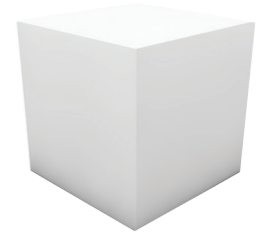

Please always send your lingual case in a shipment that can be tracked easily.

Include the following in your shipment:

- Patients RX treatment plan - completed lab form
- A silicon impressions
- Cephology chart
- Panoramic and lateral x-rays



#### GERMANY

Owner: Thomas Halbich

LINGUALTECHNIK  
Am Borsigturm 27 · 13507 Berlin, Germany

Tel.: +49 30 618 22 98 Fax: +49 30 618 71 10  
E-Mail: info@halbich-lingual.de  
Internet: www.halbich-lingual.de

#### Bonding methods:

EVOLUTION SLT™ Smart Cap indirect method

EVOLUTION SLT™ Smart Jig indirect method

JOY™ indirect modified Hiro method



#### SPAIN

Lingual Orthodontic

LADENT LAB  
Centro de ortodoncia y ATM LADENT, SL  
Lleó 11-13 1st floor, 08911 Badalona, Spain

Phone: +34 93 384 47 05 Fax: +34 93 384 41 53  
E-mail: n.pesic@centroladent.com  
Internet: www.centroladent.com

#### Bonding methods:

EVOLUTION SLT™ Smart Cap indirect method

EVOLUTION SLT™ Smart Jig indirect method

JOY™ CLO<sup>3</sup> indirect method

LAB<sup>TEC</sup> CERTIFIED



#### U.S.A

Owner: Remo Sagastume

ORTHO LINGUAL LAB  
2201 Dellcrest Lane, Spring Valley, CA U.S.A 91977

Phone: (619) 469-4356 Mobile Phone: (858) 945-0923  
Email: remo@ortholinguallab.com  
Internet: www.ortholinguallab.com

#### Bonding methods:

EVOLUTION SLT™ Smart Cap indirect method

EVOLUTION SLT™ Smart Jig indirect method

JOY™ indirect modified Hiro method

4

# A WAX BASED SET-UP WITH THE REQUIRED TOOTH POSITIONS IS MADE



A wax setup with the required tooth positions are made.

5

# LAB CONTACTS YOU TO REVIEW, CHANGE AND AUTHORIZE YOUR SET-UP

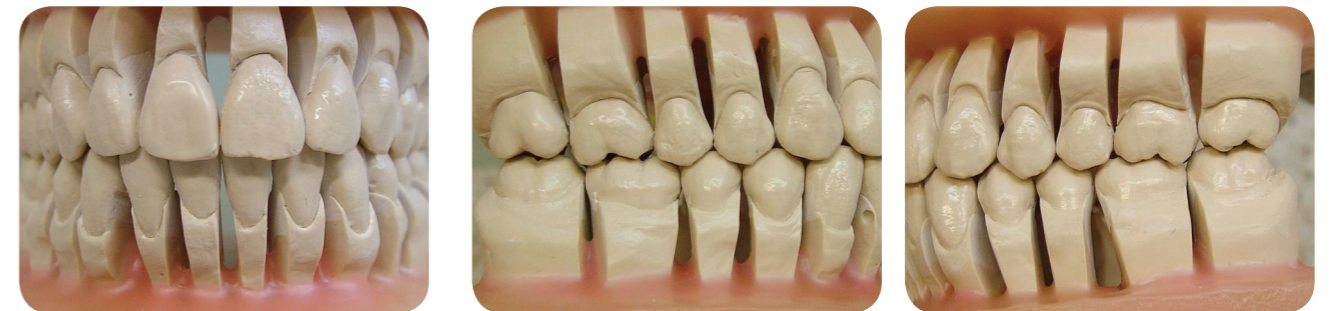

Our lingual lab will now contact you via email with digital photos of the wax set-up in ideal occlusion.

At this time you can completely review all angles of this model, and continue to make further changes or authorize for lingual bracket and tray fabrication to start.

7

# YOUR CUSTOMIZED INDIRECT BONDING KIT

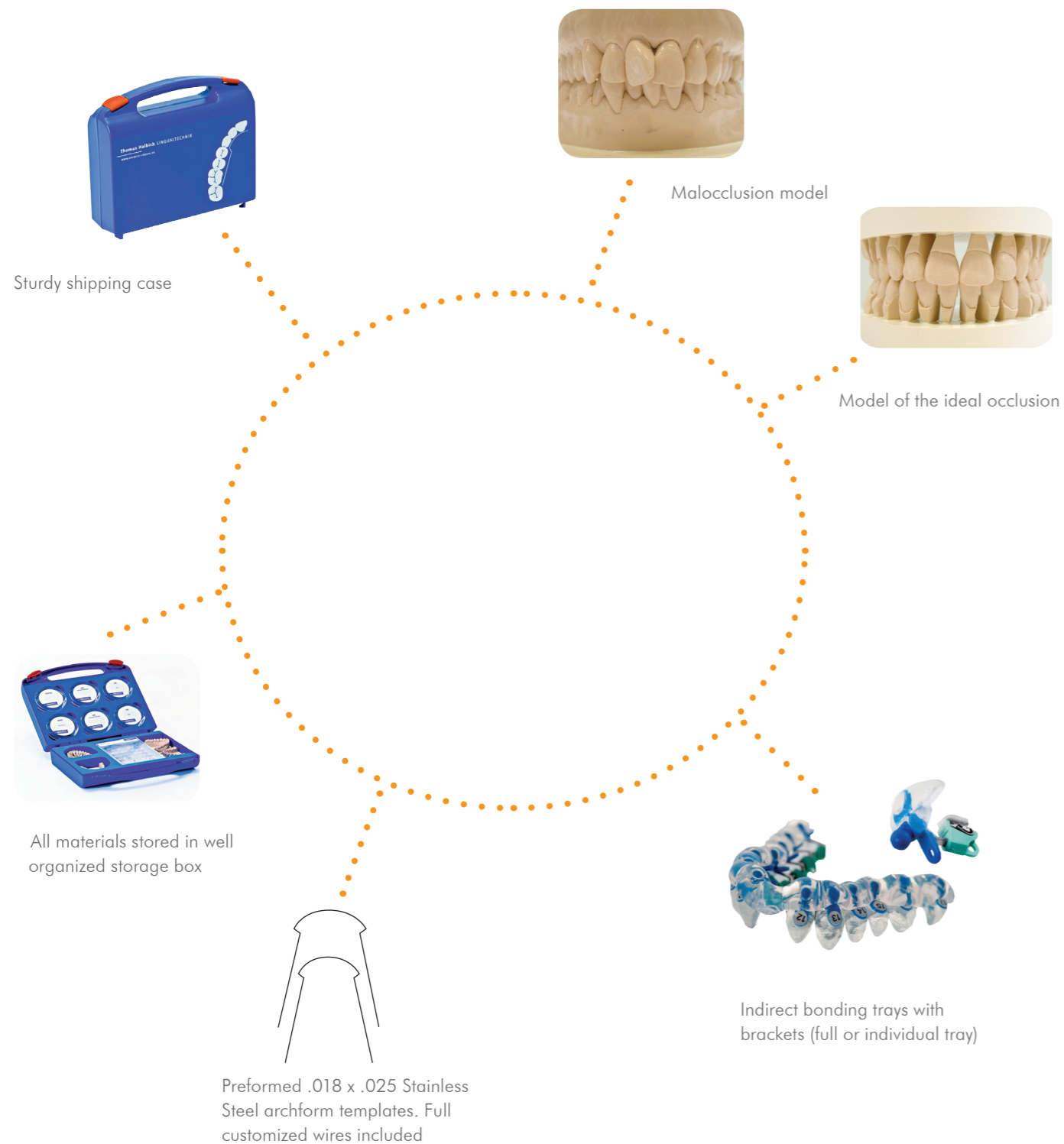

8

# BONDING PROTOCOL



Clear wing cap designed to fit snugly to the corresponding tooth.

Red wing cap is the modified form. The red plastic surfaces are supporting surfaces to the adjacent teeth. This type of cap offers completely secure form-fitting application without any slippage on unclear tooth surfaces (tray effect).

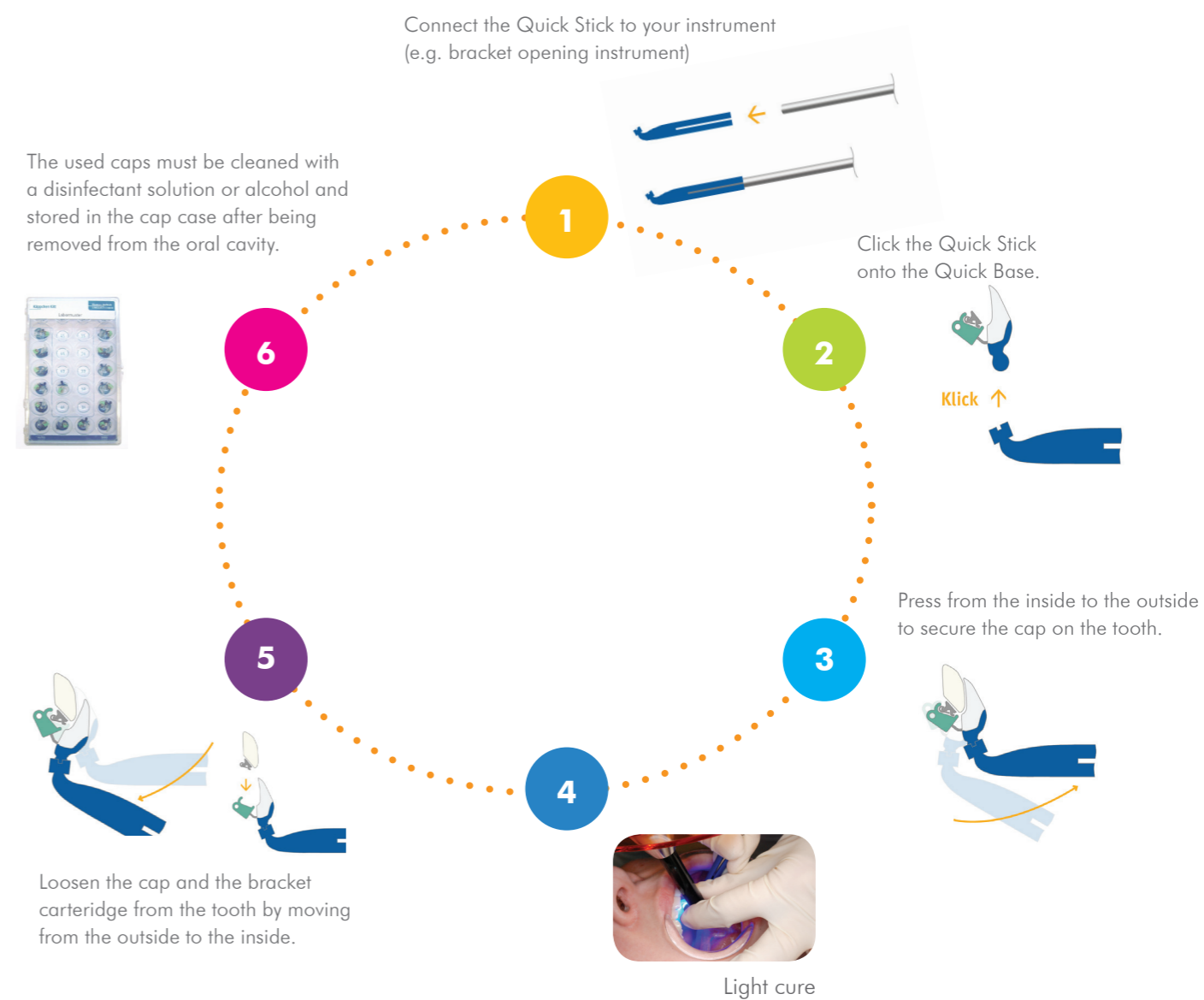

### Recommended products:

- 3M Tansbond XT - Light Cure adhesive primer
- 3M Transbond™ MIP Moisture Insensitive Primer
- Assure Primer
- 3M Unitek — Transbond LR
- 3M Unitek — Transbond Supreme LV



8

# BONDING PROTOCOL

## Using the SMART CAP & TRAY combination

The tray is designed so that the fixed plastic caps are embedded within the silicone tray and easy designed to easily compensate for any positional deviation of the teeth (impression appointment–bonding appointment).

Note regarding the full tray: If there is limited space for all caps to be bonded at once, then individual caps can be omitted accordingly, and can be either bonded individually or placed back in the silicon tray for 2nd bonding stage.

### Full tray



#### Handling the full tray:

- After the bonding process (number of caps, segmentation) has been defined, the tooth surfaces must be prepared accordingly
- Apply Transbond Supreme LV to the composite bases
- Position the tray. Hold in position on the row of teeth with a small amount of pressure
- Cure intensively with light (check curing light)

### Every other tray



#### Handling an every other tray:

- The two trays are used one after the other. Only every second bracket is bonded in this procedure. The advantage is that there are optimal space conditions for light polymerization
- See also single tray
- We recommend bonding molars separately.

### Removal of the silicon tray



The silicone tray is removed by its end from the ball heads of the quick base. Support this procedure with your finger, keeping the caps pressed down on the tooth surface from the vestibular.

### Removal of SMART CAPS



Loosen the cap and the bracket carteridge from the tooth by moving from the outside to the inside.

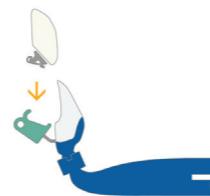

#### NOTE:

The used caps must be cleaned with a disinfectant solution or alcohol and stored in the cap case after being removed from the oral cavity. Do not discard the caps.



8

# RE-BONDING WITH THE SMART CAP

## Rebonding instructions with the Adenta Evolution SLT bracket







Head Office  
adenta GERMANY

Adenta GmbH  
Gutenbergstrasse 9  
D-82205 Gilching  
Germany

+49 8105 - 73436 - 0  
+49 8105 - 73436 - 22

Mail: [info@adenta.com](mailto:info@adenta.com)  
[www.adenta.com](http://www.adenta.com)

Sales Office  
adenta SPAIN

Adenta Spain S.L.  
c/León, 11,  
08911 Badalona  
Barcelona España

T. +34 933 844 705  
F. +34 933 844 153

[info@adentaspain.com](mailto:info@adentaspain.com)  
[www.adentaspain.com](http://www.adentaspain.com)

Sales Office  
adenta USA

Adenta USA Inc  
81 Clover Road  
Ivlyland PA 18974  
U.S.A

1-888-942-2070 toll free  
T. +1-215-942-2070

[info@adentausa.com](mailto:info@adentausa.com)  
[www.adentausa.com](http://www.adentausa.com)